

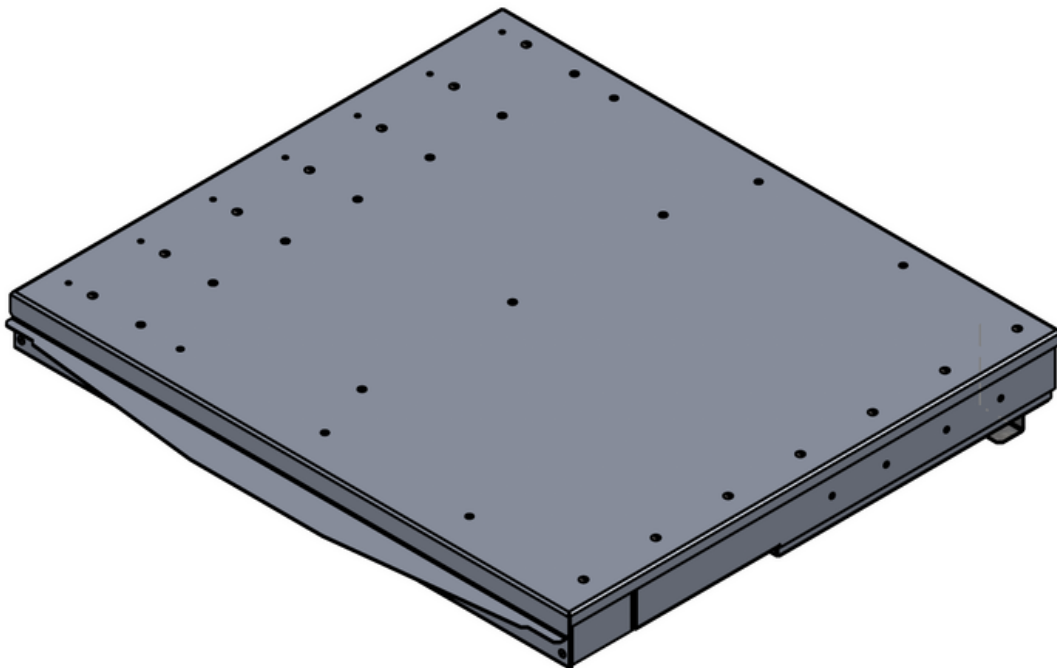

INSTALLATION INSTRUCTIONS

For units using CTU-1000 base



CTU-1000 BASE INSTALL INSTRUCTIONS

FOR 5TH GENERATION (2021 - CURRENT) CHEVROLET TAHOE

STEP 1:
FLIP UP THE 2ND ROW SEATS FOR MORE ROOM.

MAKE A HOLE ON THE RUBBER MAT FLOOR COVERING ON TOP OF THE REAR INSTALLATION HOLE. MAKE SURE THE REAR BRACKETS (SUPPLIED BY OPS) ARE FULLY SEATED ON THE SHEET METAL OF THE VEHICLE TO BE PROPERLY INSTALLED. MAKE A 1" HOLE ON THE RUBBER MAT FLOOR COVERING ON TOP THE THE FRONT INSTALLATION HOLE.

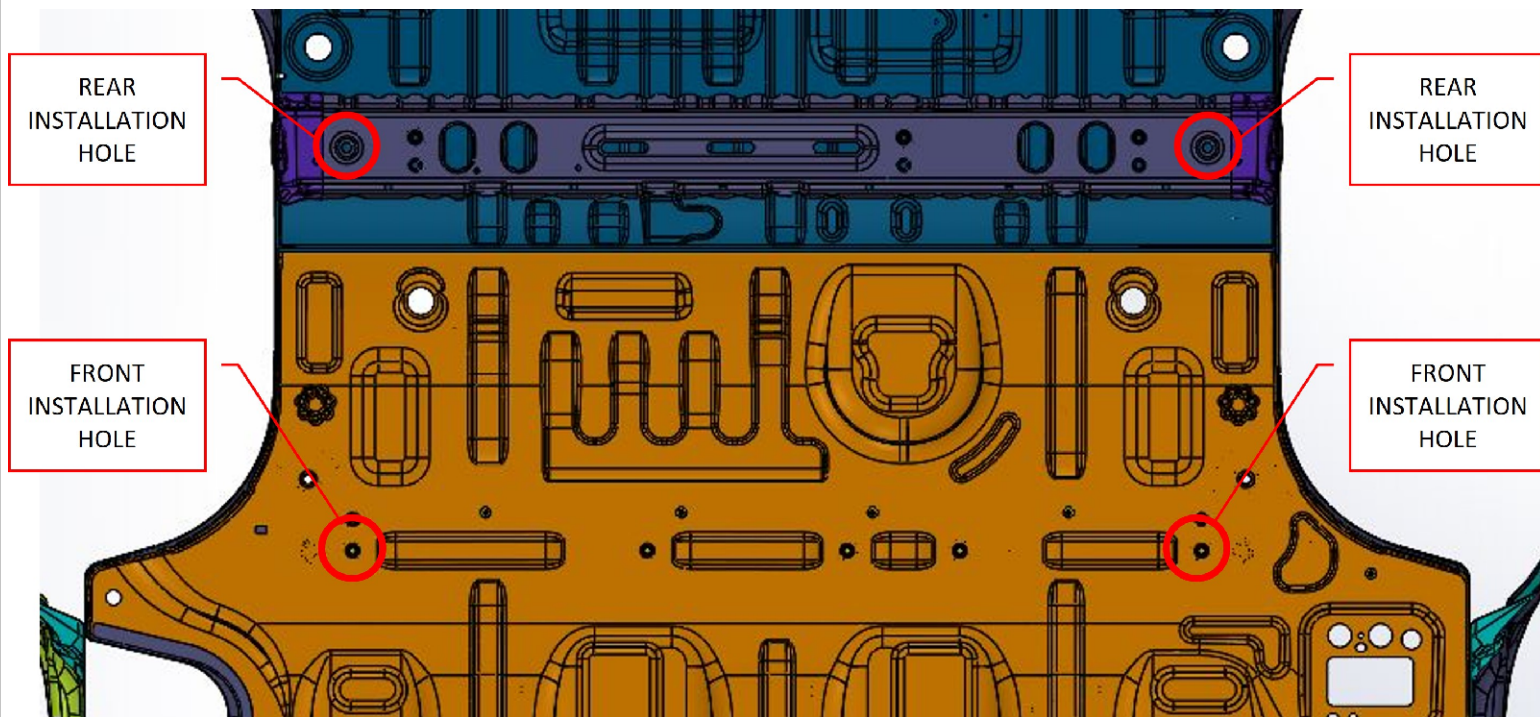

(TOP VIEW OR CARGO SPACE, RUBBER MAT IS NOT SHOWN)

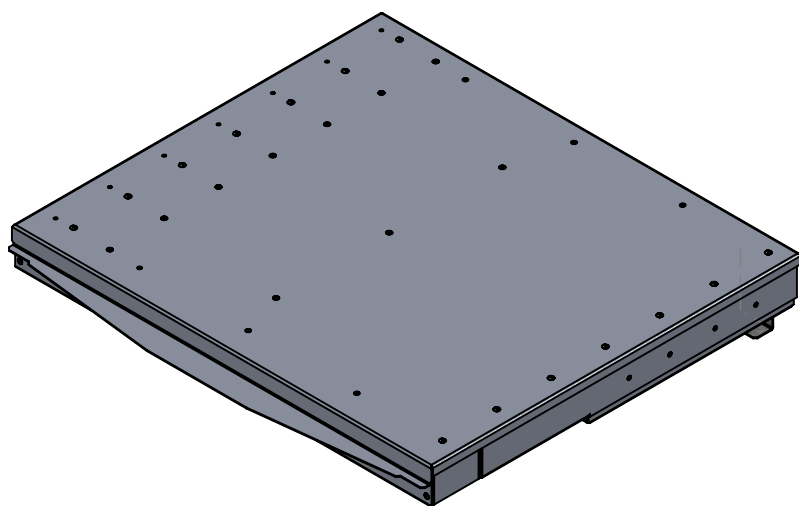

HARDWARE PROVIDED:

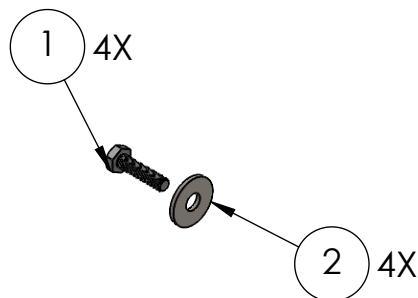

ITEM NO.	PART NUMBER	INSTALL HARDWARE	QTY.
1	1441064	BOLT, HEX HEAD, M10-1.5MM, 40MM L, CLASS 8.8, ZINC PLATED STEEL	4
2	1229434	WASHER, FENDER, M12, 37MM OD, ZN PLATED STEEL	4
3	4005717	FOAM TAPE, 1/16" THICK X 1/2" W, NEOPRENE (1411025), 16" L	1

STEP 2:
UNSCREW AND REMOVE THE TOP PANEL.

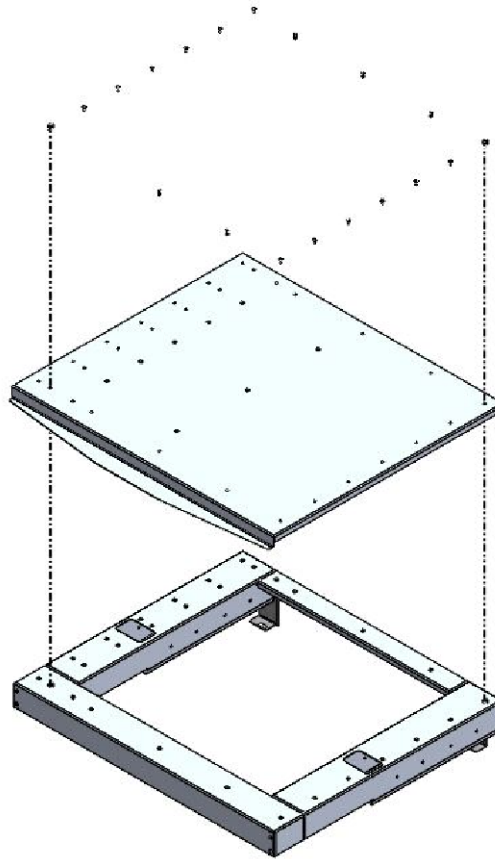

STEP 3:
PLACE THE BASE INSIDE THE VEHICLE FROM THE TAILGATE. ALIGN THE BASE WITH THE FOUR HOLES SHOWN IN STEP 1 AND FIX THE BASE USING THE HARDWARE PROVIDED ① AND ②.

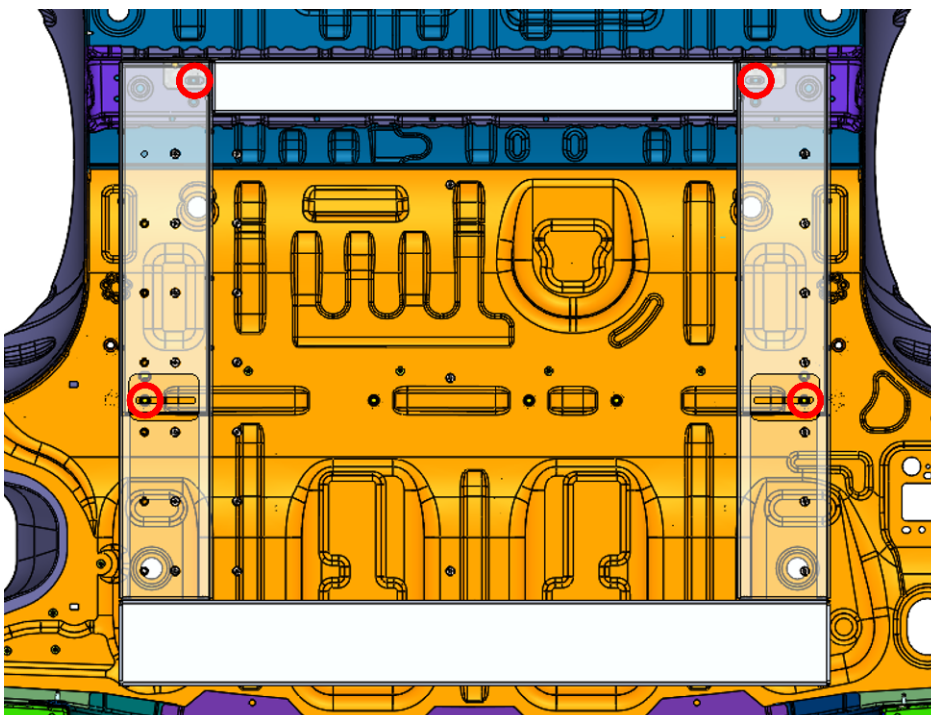

(SOME PARTS ARE SHOWN TRANSPARENT FOR CLARITY)

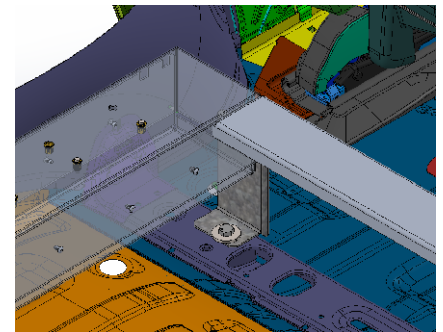

REAR INSTALLATION BOLT
(DRIVER SIDE)

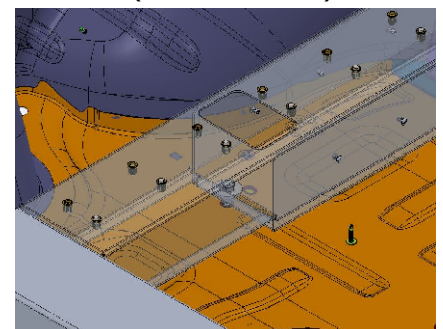

FRONT INSTALLATION HOLES
(DRIVER SIDE)

STEP 4:

PLACE BACK THE TOP PANEL ON THE BASE. DO NOT FASTEN THE SCREWS YET.

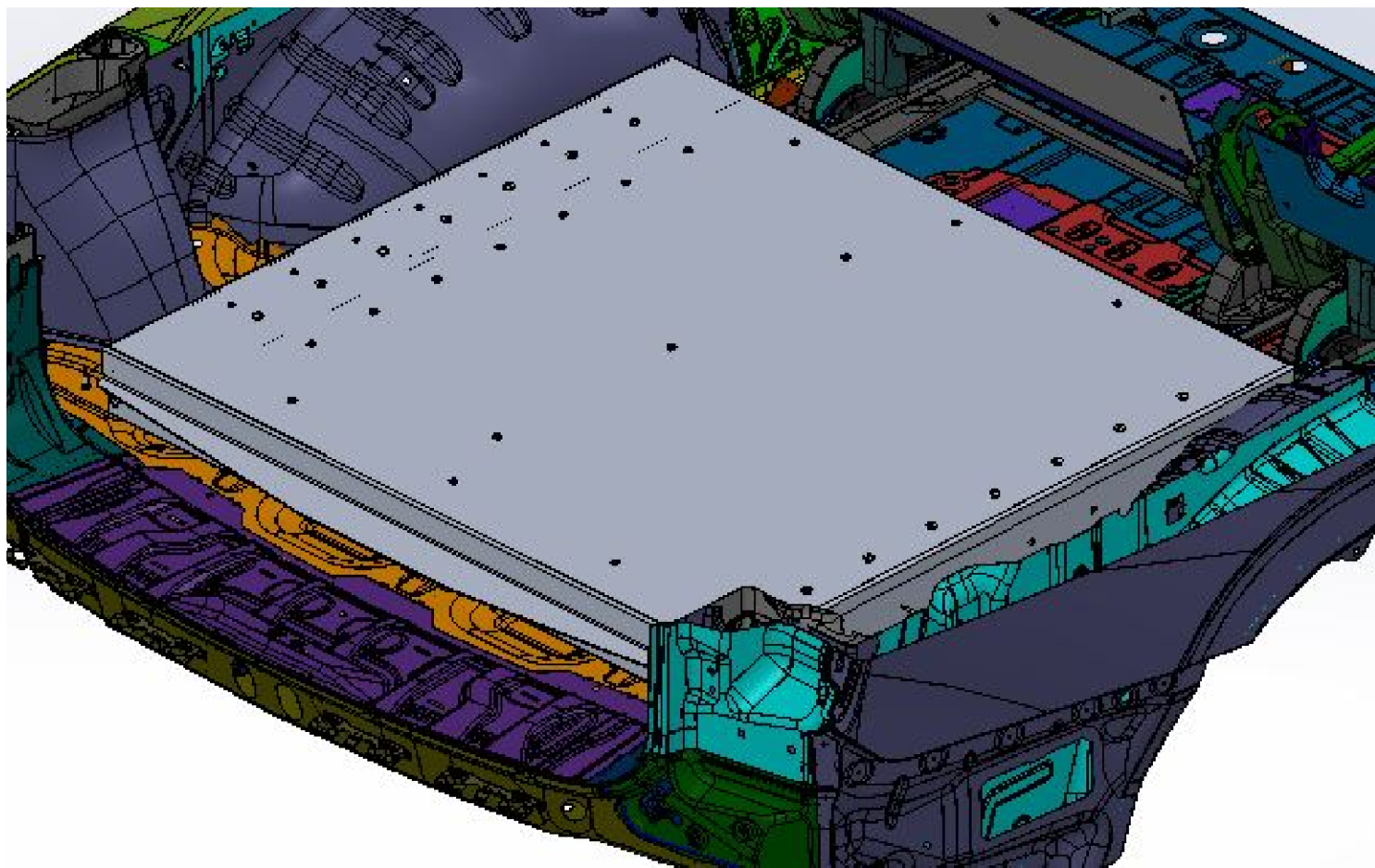

STEP 5:

REMOVE THE BOTTOM DRAWER FROM OPS CABINET BY OPENING IT TO FULL EXTENSION AND PUSHING THE PLASTIC TABS IN OPPOSITE DIRECTIONS LOCATED ON SLIDES ON BOTH SIDES OF THE DRAWER WHILE PULLING THE DRAWER STRAIGHT OUT.

FOR DRAWERS THAT ARE FASTENED BY NUTS, FIRSTLY PULL OUT THE DRAWER THEN SIMPLY UNFASTEN THE NUTS AND REMOVE THE BOLTS ON BOTH SIDES OF THE DRAWER.

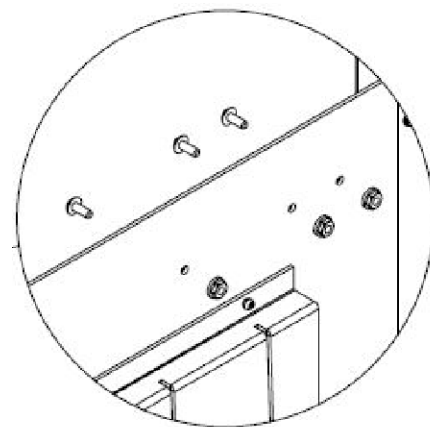
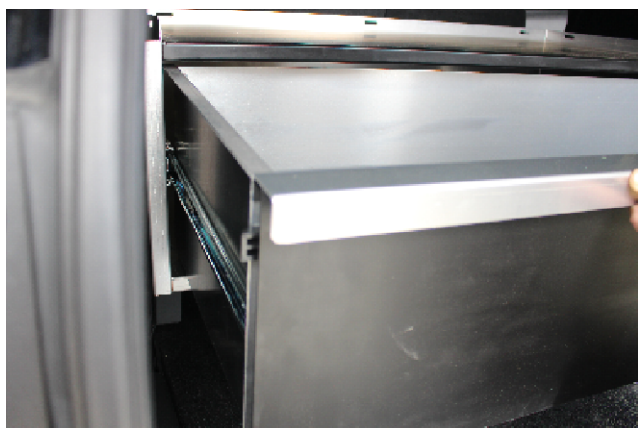

(SLIDES THAT USES NUT AND BOLT FASTENERS)

STEP 6:

ATTACH THE FOAM TAPE (SUPPLIED WITH THE INSTALL KIT) ON THE BOTTOM OF THE CABINET'S CROSS BRACE (FOR RATTLE NOISE PREVENTION).

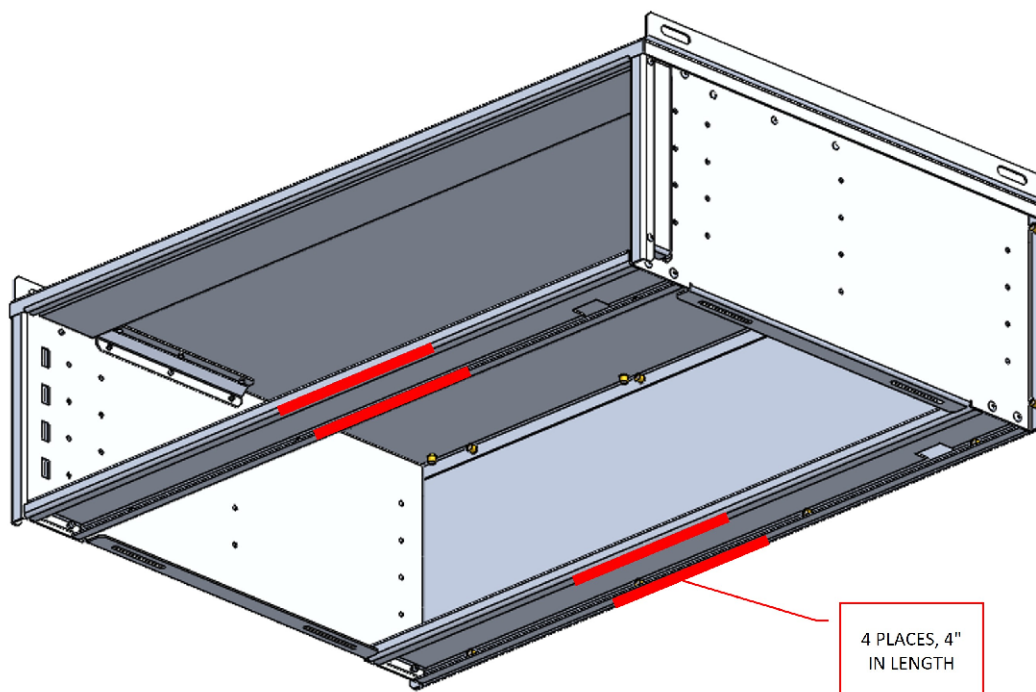
**STEP 7:**

PLACE THE CABINET ONTO THE BASE AND ALIGN THE SLOTS OF THE CABINET WITH THE RIV NUTS UNDERNEATH AND FIX THE CABINET USING THE SCREWS PROVIDED WITH THE BASE.

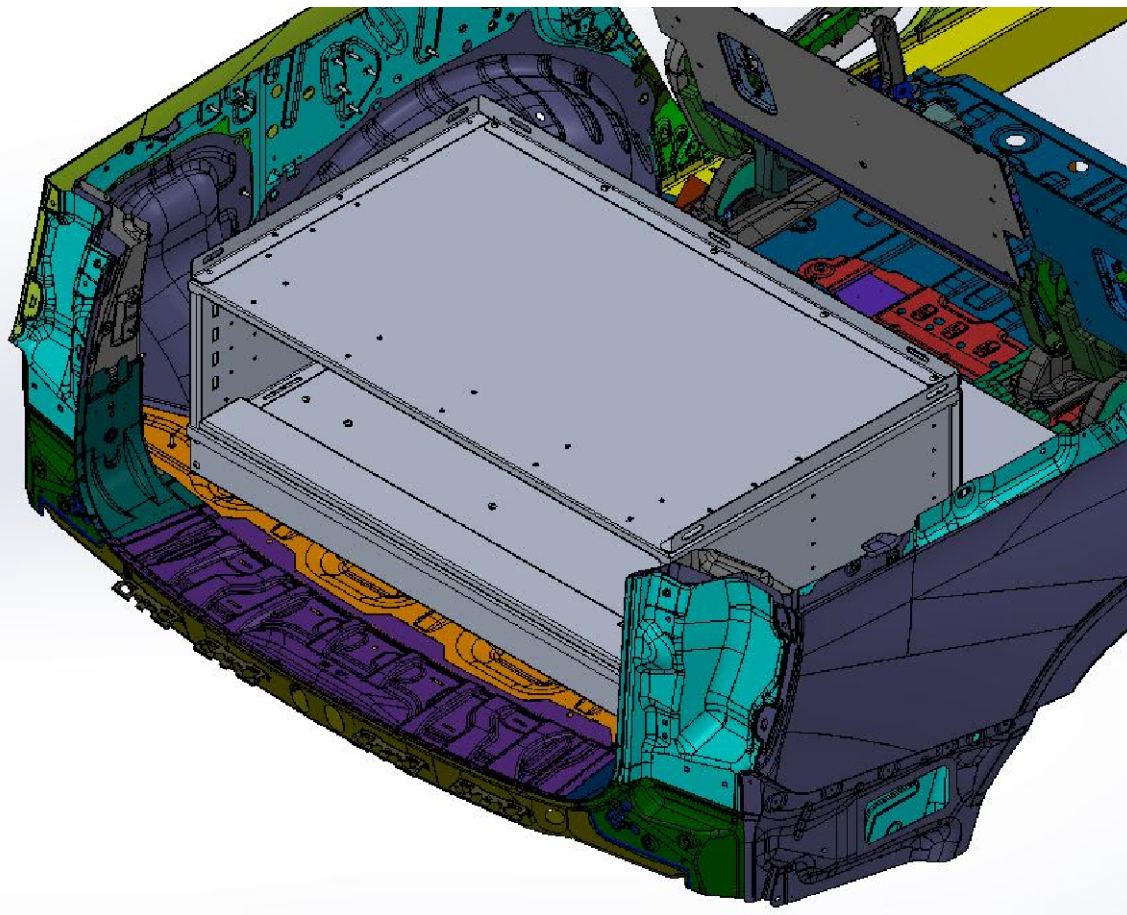

ALIGN THE PASSENGER SIDE MOUNTING HOLES OF THE CABINET TO THE PASSENGER SIDE MOUNTING HOLES. THE DRIVER SIDE MOUNTING HOLES WILL ALIGN BASED ON CABINET WIDTH:

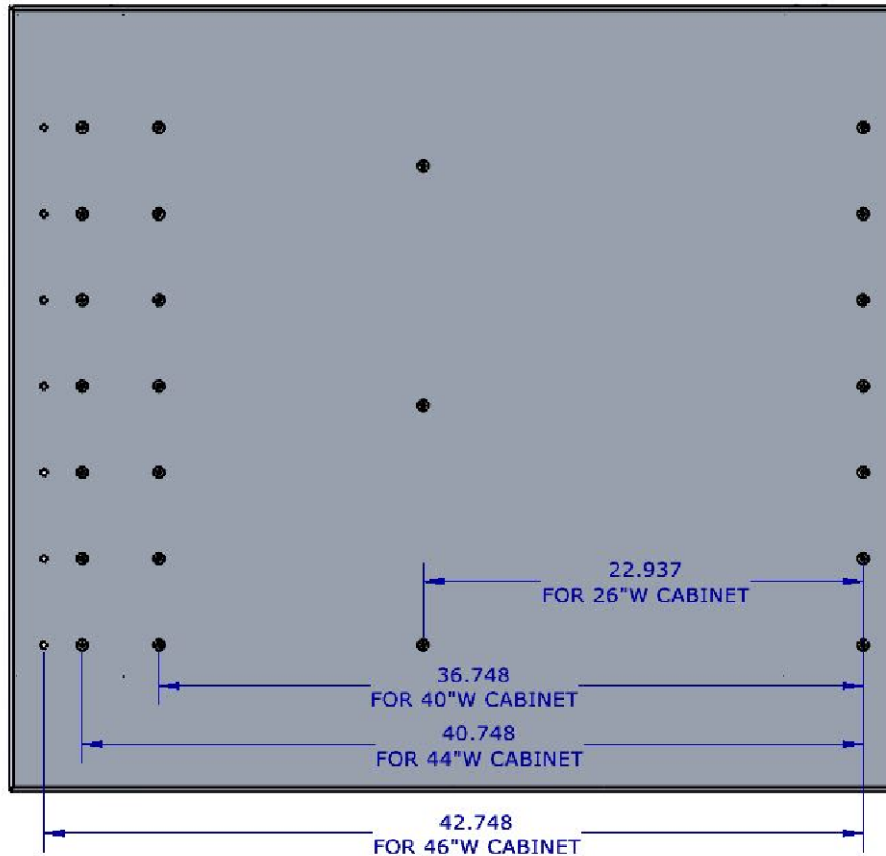

STEP 8:

PLACE THE DRAWER BACK INTO THE CABINET BY ALIGNING THE SLIDES ON EACH SIDE AND PUSHING THE DRAWER STRAIGHT IN UNTIL FULLY CLOSED. **DO NOT FORCE.** THE INSTALLATION IS NOW COMPLETE.

